

ASSEMBLY INSTRUCTION

ITEM NO.:V81395GY/V81395BK

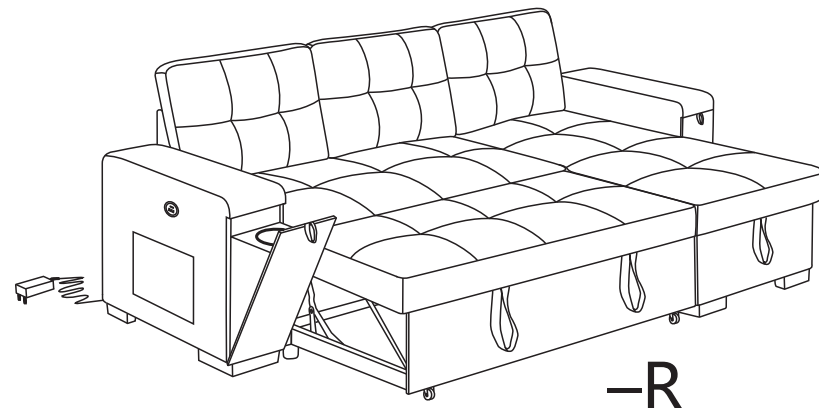

PARTS LIST

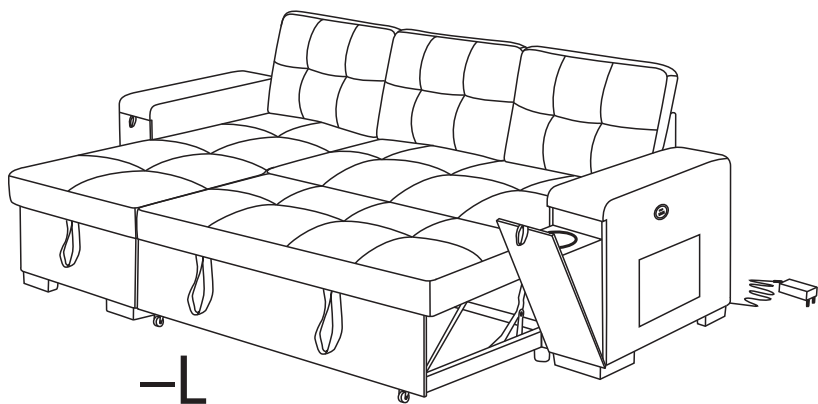
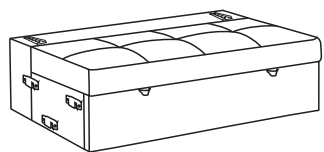

A

X1

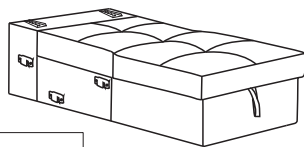

B

X1

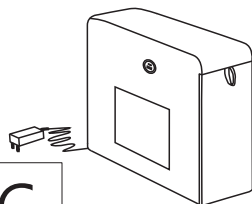

C

X1

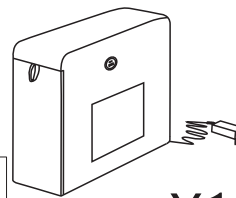

D

X1

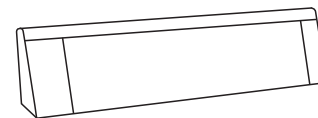

E

X1

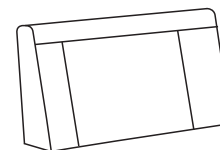

F

X1

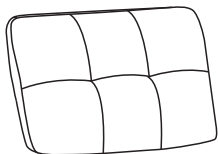

G

X1

HARDWARE LIST

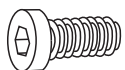

M6X25

1

X8



M4

2

X1



M5X50

3

X12



4

X4

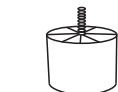

∅60x50mm

5

X6



150x150x50mm

6

X6

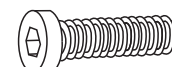

M8X60

7

X6



M5

8

X1

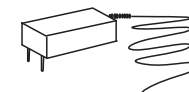

9

X2

BOX -1 HARDWARE LIST

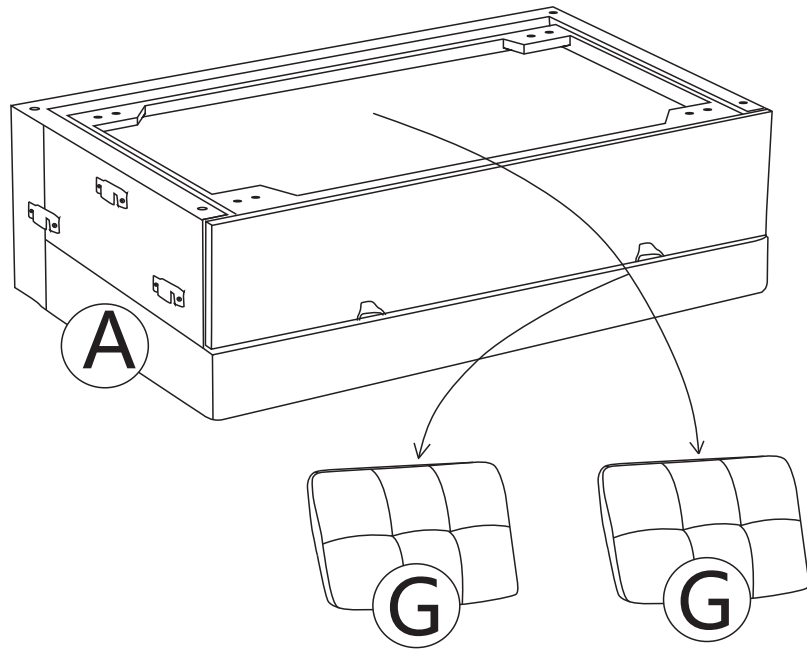

BOX -2 HARDWARE LIST

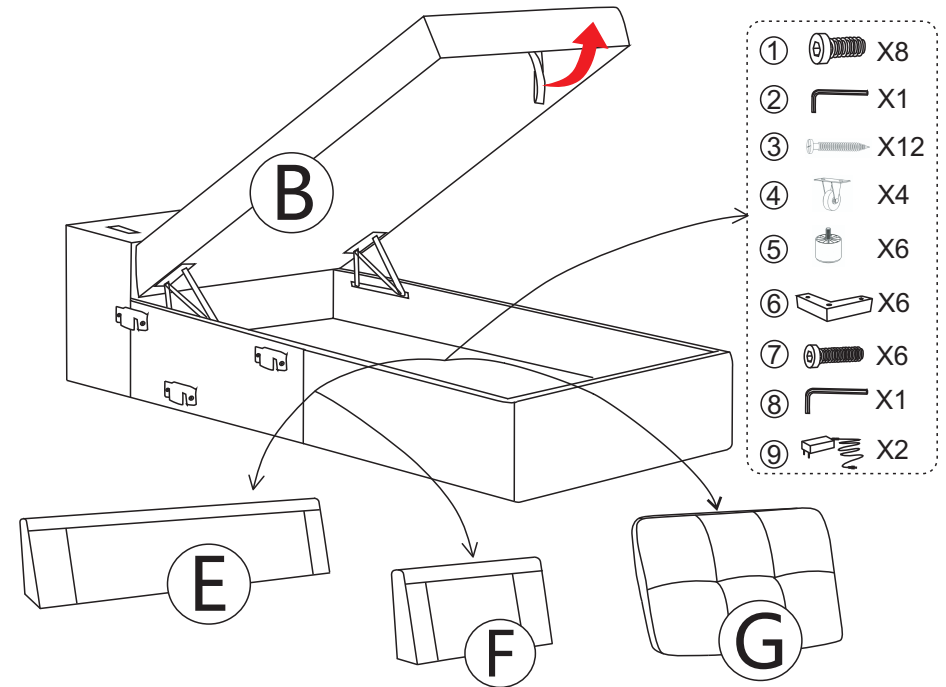

BOX -3 HARDWARE LIST

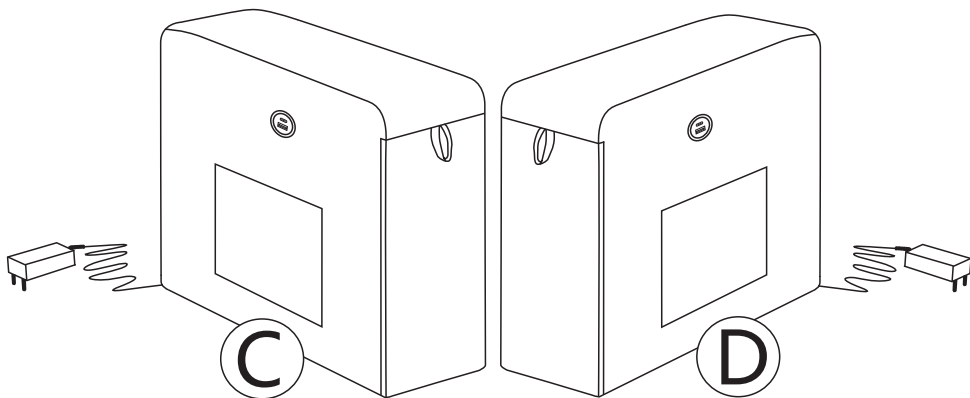

Unpacking steps:

- 1. BOX-2**
- 2. BOX-1**
- 3. BOX-3**

Step1-L/R

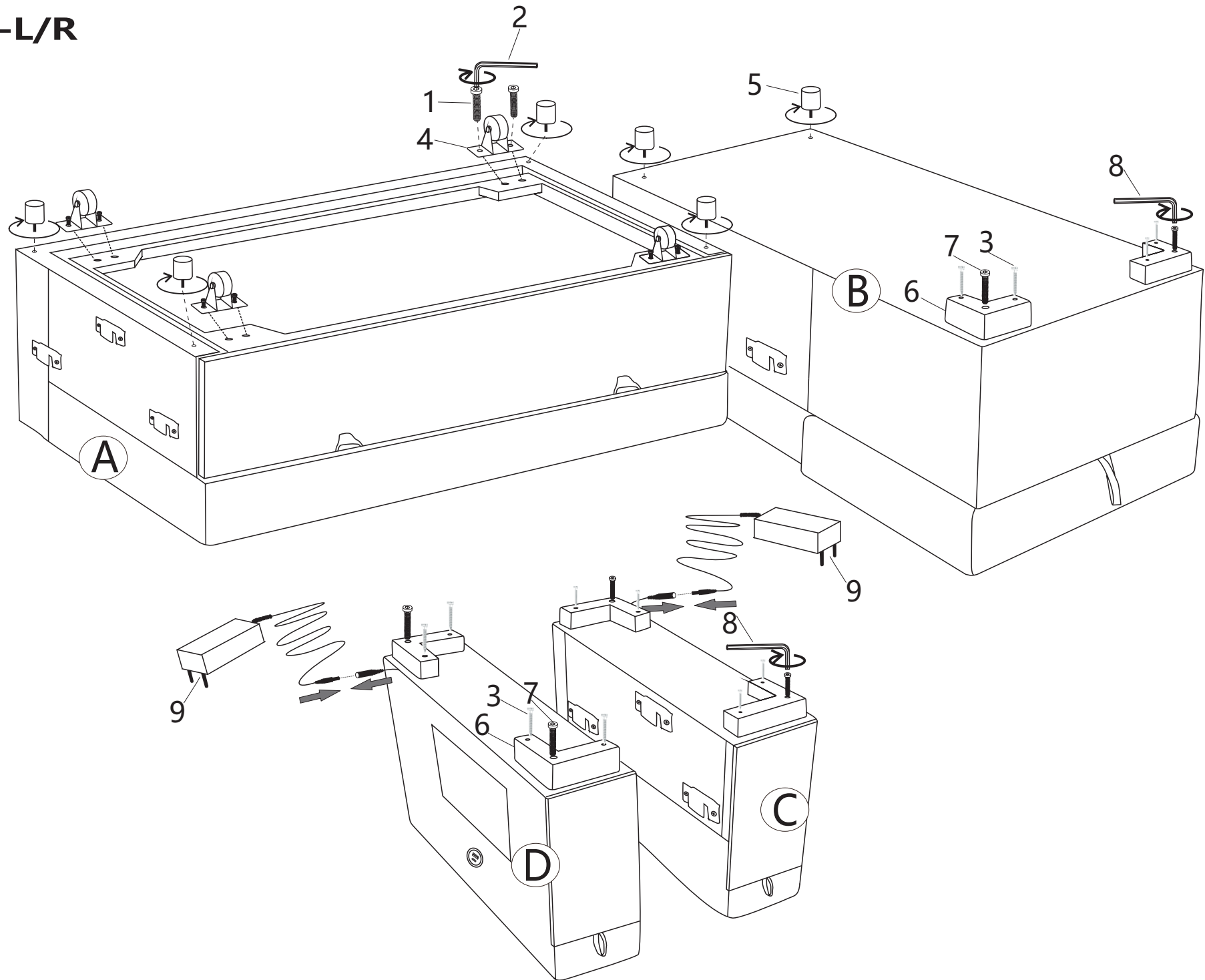

Step2-L/R

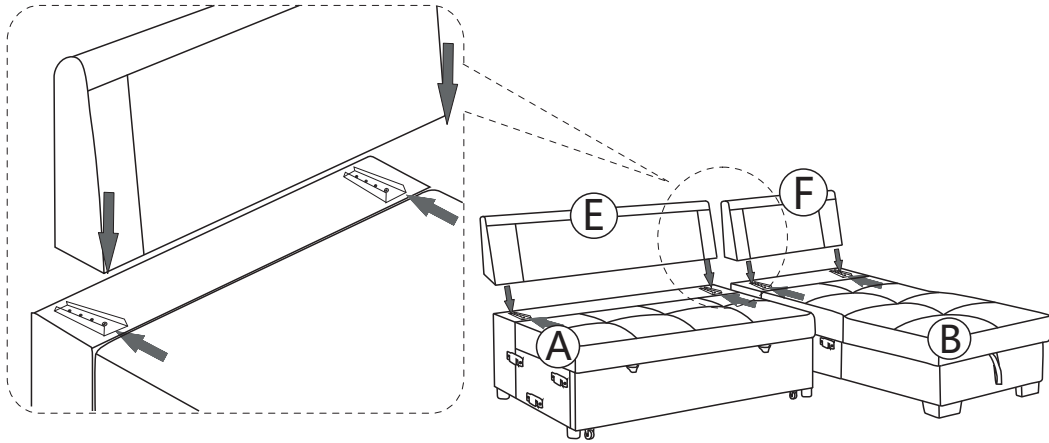

Step3-R

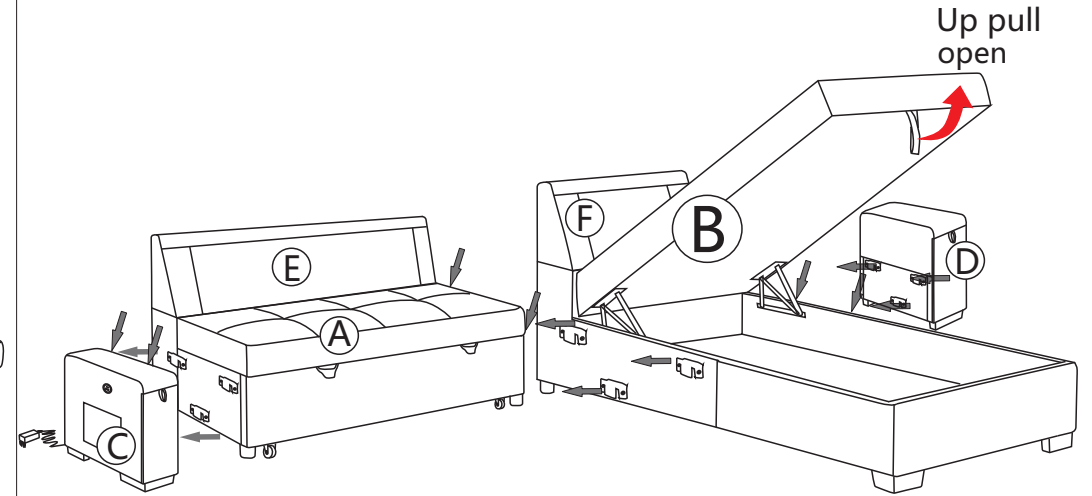

Step4-R

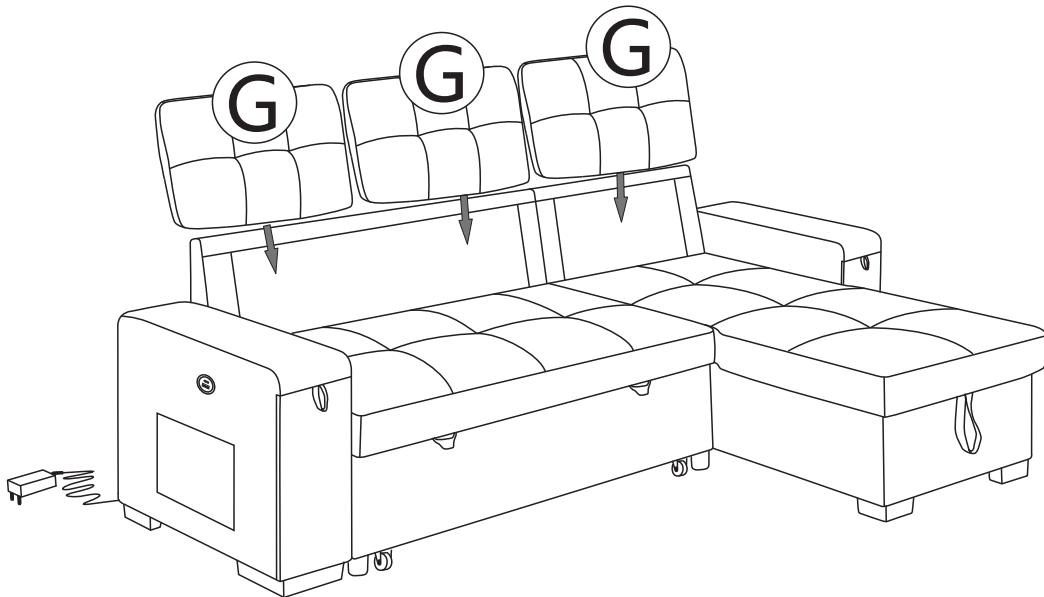

Step5-R

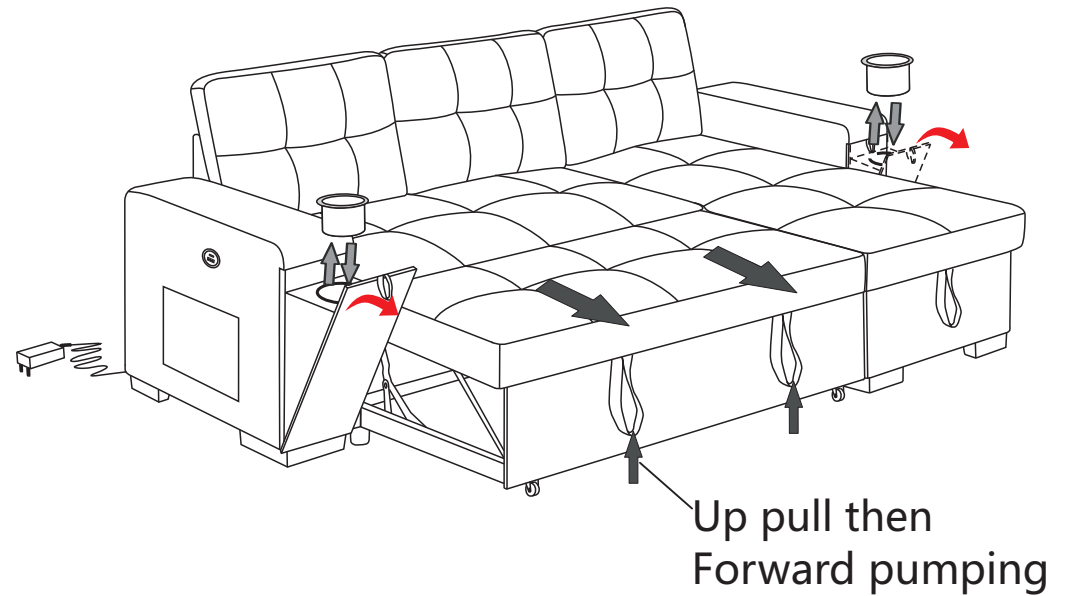

Step3-L

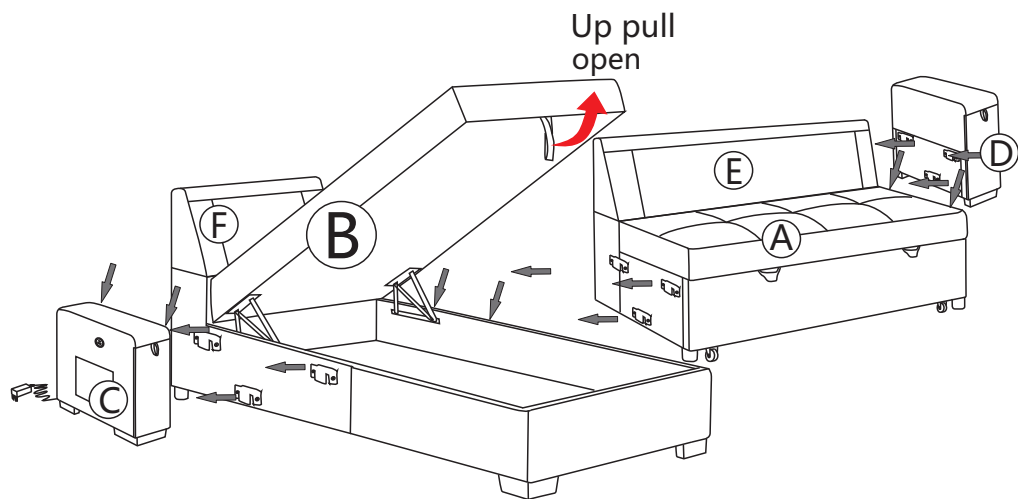

Step4-L

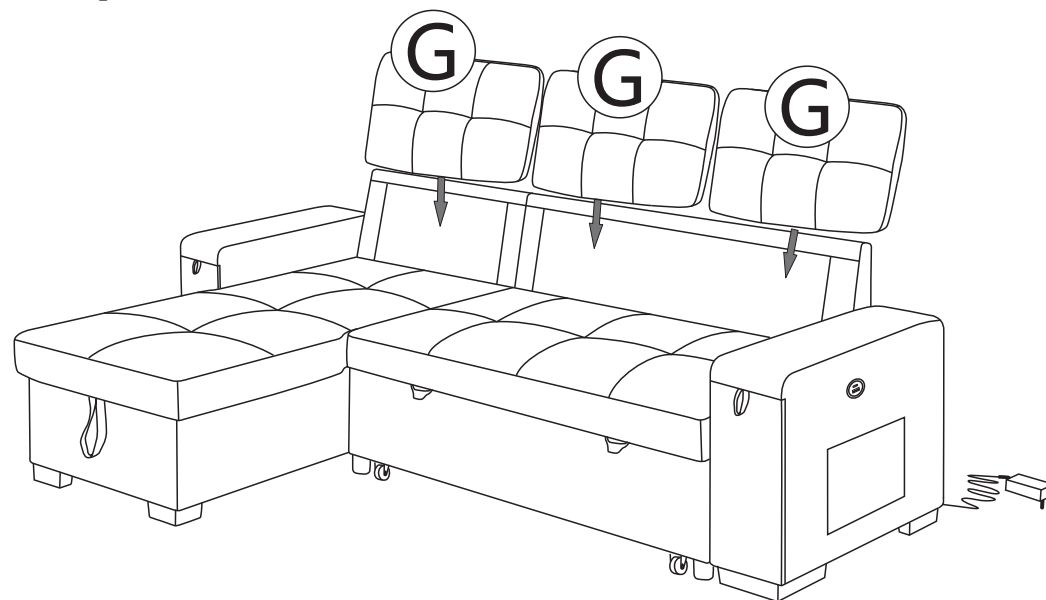

Step5-L

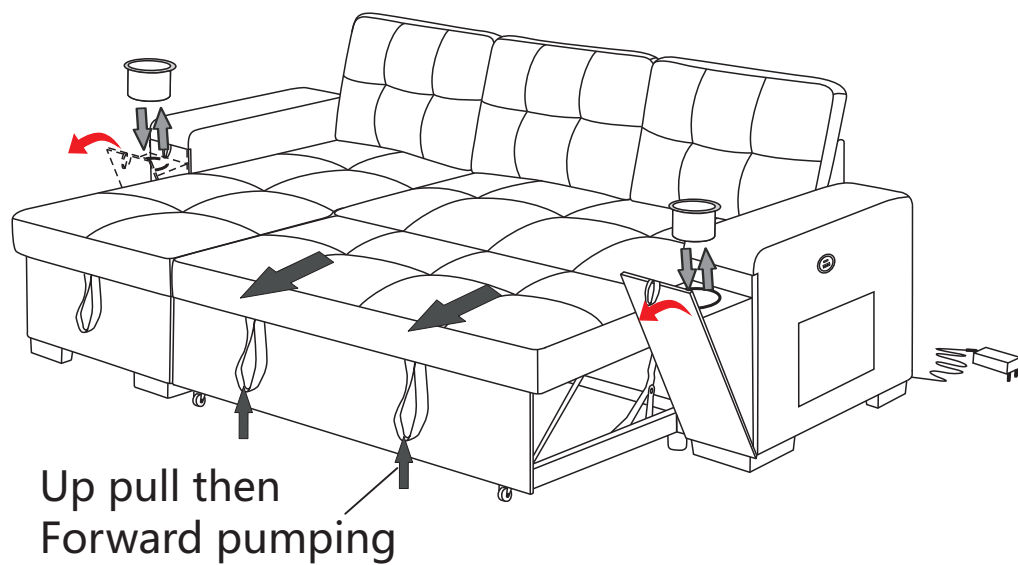

Step6-L

