

ASSEMBLY INSTRUCTIONS

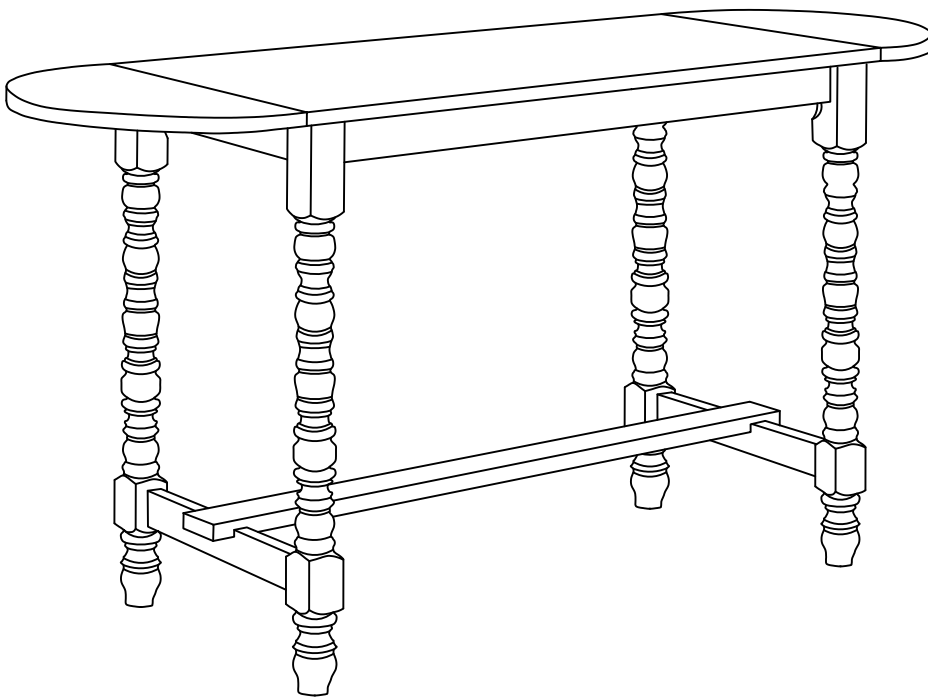

TOOLS REQUIRED



Allen Wrench

(Included)



Phillips
Screwdriver

(Not Included)



**2 - People
Recommended**

ASSEMBLY RATING



EASY —————> DIFFICULT

The Assembly Rating is a 5-point system showing the level of effort needed to assemble a specific product.



CHECK BEFORE STARTING

Are you missing anything?

Double-check all parts, hardware and accessories listed are all accounted for.

Check out our Quick Tips!

We recommend reviewing the pre-assembly handouts. Even experts need a refresher now and then!

Should we send any replacements?

Are there any irregularities or flaws in the parts? We can send replacements!

Prep Time!

Please review the assembly instructions and all diagrams prior to assembling.

PRE ASSEMBLY INTRODUCTION

We understand building ready-to-assemble furniture can be a challenging experience for some. To help avoid confusion, we have provided some helpful tips that may speed up the process.



Teamwork

ALWAYS have at least two people to help with transporting and assembling the product to avoid potential injury and/or damage.



Suitable Location

Assembling near the area of the intended location is highly recommended.



Sufficient Space

Make sure you have enough space to move around during the assembly.



Avoid Scratches

Use cardboard, blankets or a carpeted area while assembling furniture to prevent to prevent scratches and damages.



Flat Surface

Make sure the furniture rests on a flat and level surface with each leg evenly touching the floor.

ASSEMBLY AND CARE ADVICE



FAILURE TO FOLLOW THE GUIDELINES BELOW MAY RESULT IN INJURY AND/OR PROPERTY DAMAGE.



Position each part correctly and insert screws or bolts into their respective holes.



Turn clockwise to tighten and only tighten when step is completed or when instructed to do so.



Use the appropriate hand tools or power tools for assembly. Select steps, such as tightening screws and/or bolts, may require hand tools to avoid causing damage during assembly.



Save the instructions and store any supplied tools for later maintenance.



After two weeks, check and tighten any loose hardware and repeat again every six months thereafter.

IT IS THE USER'S RESPONSIBILITY TO MAINTAIN THE FURNITURE. THE HARDWARE MAY LOOSEN OVER TIME AND MAY CAUSE THE FURNITURE TO BE WOBBLY AND UNABLE TO SUPPORT ITS INTENDED WEIGHT CAPACITY. THIS MAY LEAD TO COLLAPSE AND MAY CAUSE SERIOUS INJURY.

COUNTER HEIGHT TABLE WITH 2x 12" DROP LEAF

CM3584-PT

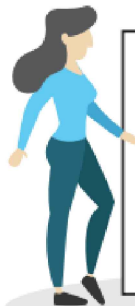

- Please keep instructions for future reference.
- Check the quantity and irregularity of parts and hardware before you start.

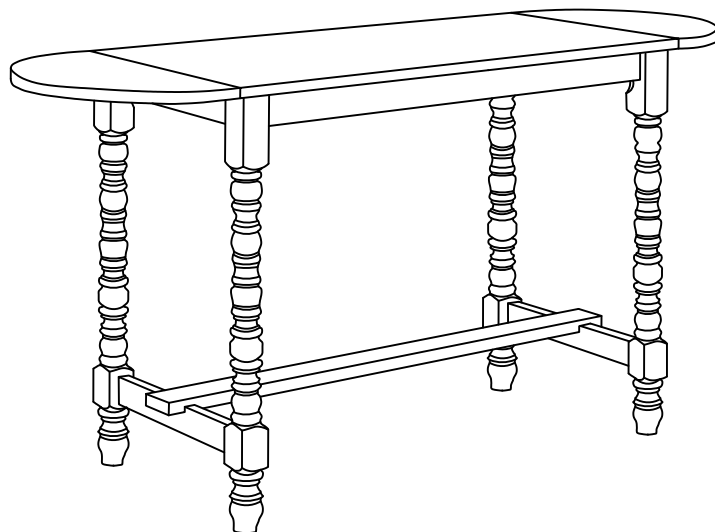

PARTS

#1 2pcs



Table Leg ①

#2 2pcs



Table Leg ②

#3 1pc

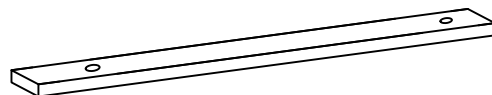

Base Stretcher

#4 1pc

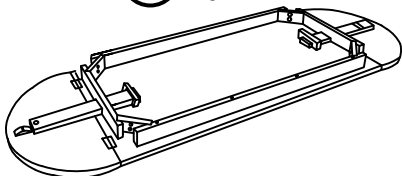

Table Top

#5 2pcs



Side Stretcher

HARDWARE

#A 2pcs



M6 x 50MM
Bolt

#B 8pcs

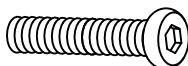

M8 x 60MM
Bolt

#C 2pcs



M6 x 13MM
Spring Washer

#D 8pcs



M8 x 14MM
Spring Washer

#E 2pcs



M6 x 14MM
Flat Washer

#F 8pcs



M8 x 22MM
Flat Washer

#G 4pcs



M4 x 45MM
Pan Head Screw

#H 1pc

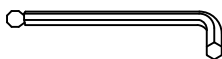

M4 Allen Wrench
With Ball End

#I 1pc

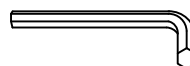

M5 Allen Wrench

#J 4pcs



Felt Pad

ASSEMBLY INSTRUCTIONS

1

- Part #1 x1pc
- Part #2 x1pc
- Part #4 x1pc
- Part #5 x1pc
- Hardware #B x4pcs
- Hardware #D x4pcs
- Hardware #F x4pcs
- Hardware #I x1pc

Connect Table Leg (#1,2) with Side Stretcher (#5), then secure both Table Legs (#1,2) to Table Top (#4) by using bolts (#B) with washers (#D,F).

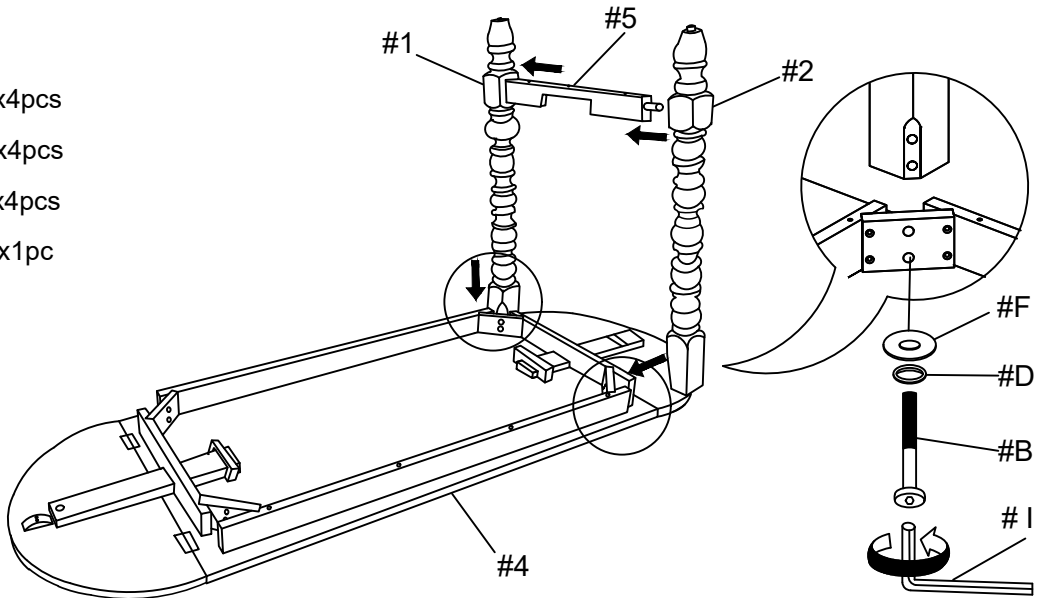

2

- Part #1 x1pc
- Part #2 x1pc
- Part #5 x1pc
- Hardware #B x4pcs
- Hardware #D x4pcs
- Hardware #F x4pcs
- Hardware #I x1pc

Connect Table Leg (#1,2) with Side Stretcher (#5), then secure both Table Legs (#1,2) to Table Top (#4) by using bolts (#B) with washers (#D,F).

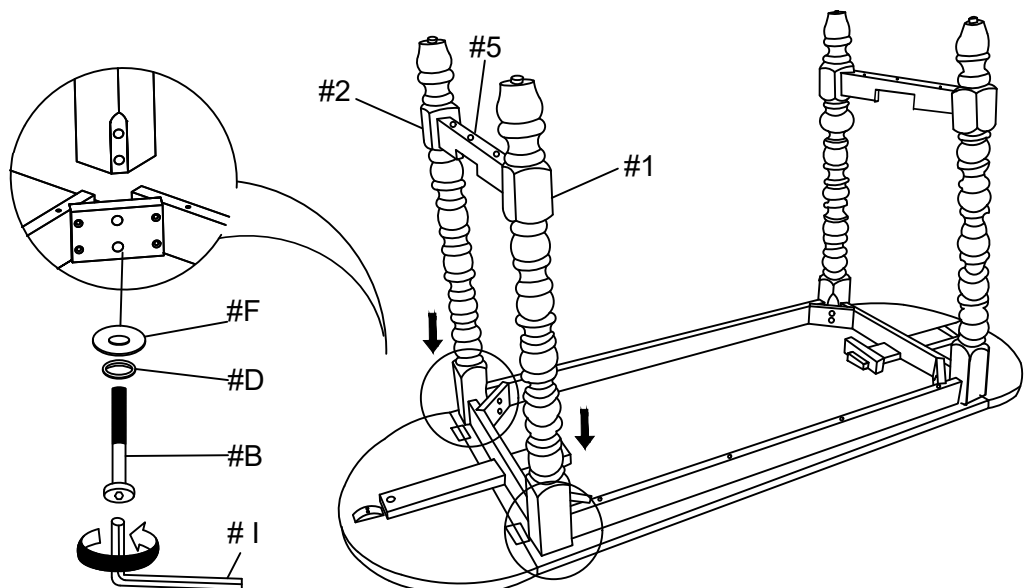

ASSEMBLY INSTRUCTIONS

3

Align Base Stretcher (#3) to the Side Stretcher (#5), secure by using bolts (#A) with washers (#C,E). Secure all Side Stretchers by using Pan Head Screw (#G).

- Part (#3) x1pc
- Hardware (#A) x2pcs
- Hardware (#C) x2pcs
- Hardware (#E) x2pcs
- Hardware (#H) x1pc

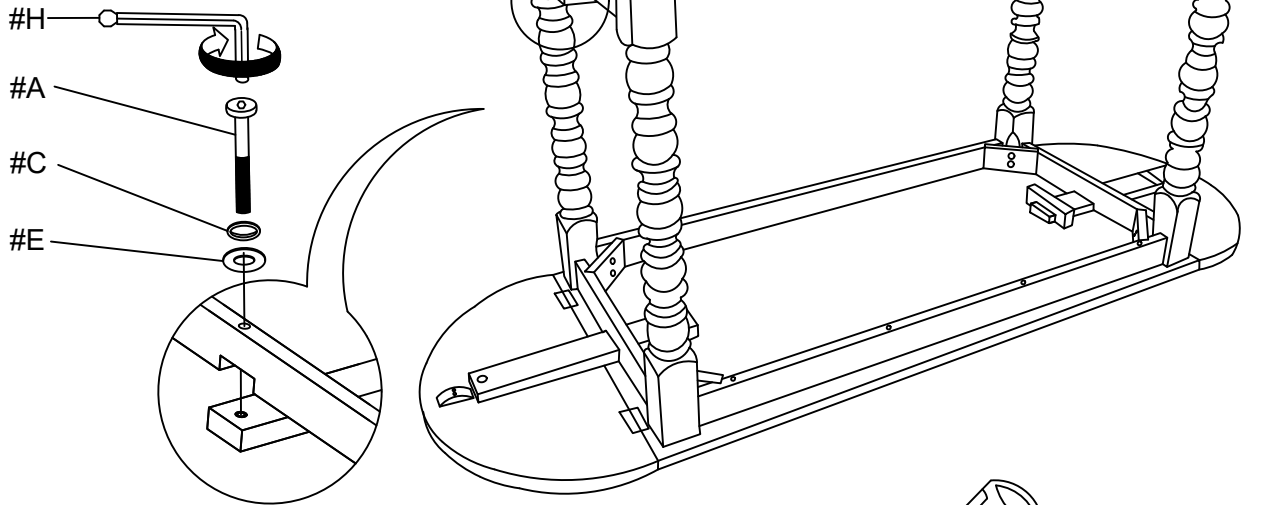

4

- Hardware (#J) x4pcs
- Hardware (#G) x4pcs

Secure all Side Stretchers by using Pan Head Screw (#G). Remove the adhesive backing of Felt Pad (#J), affix it to the back of the table leaf according to the measurements illustrated.

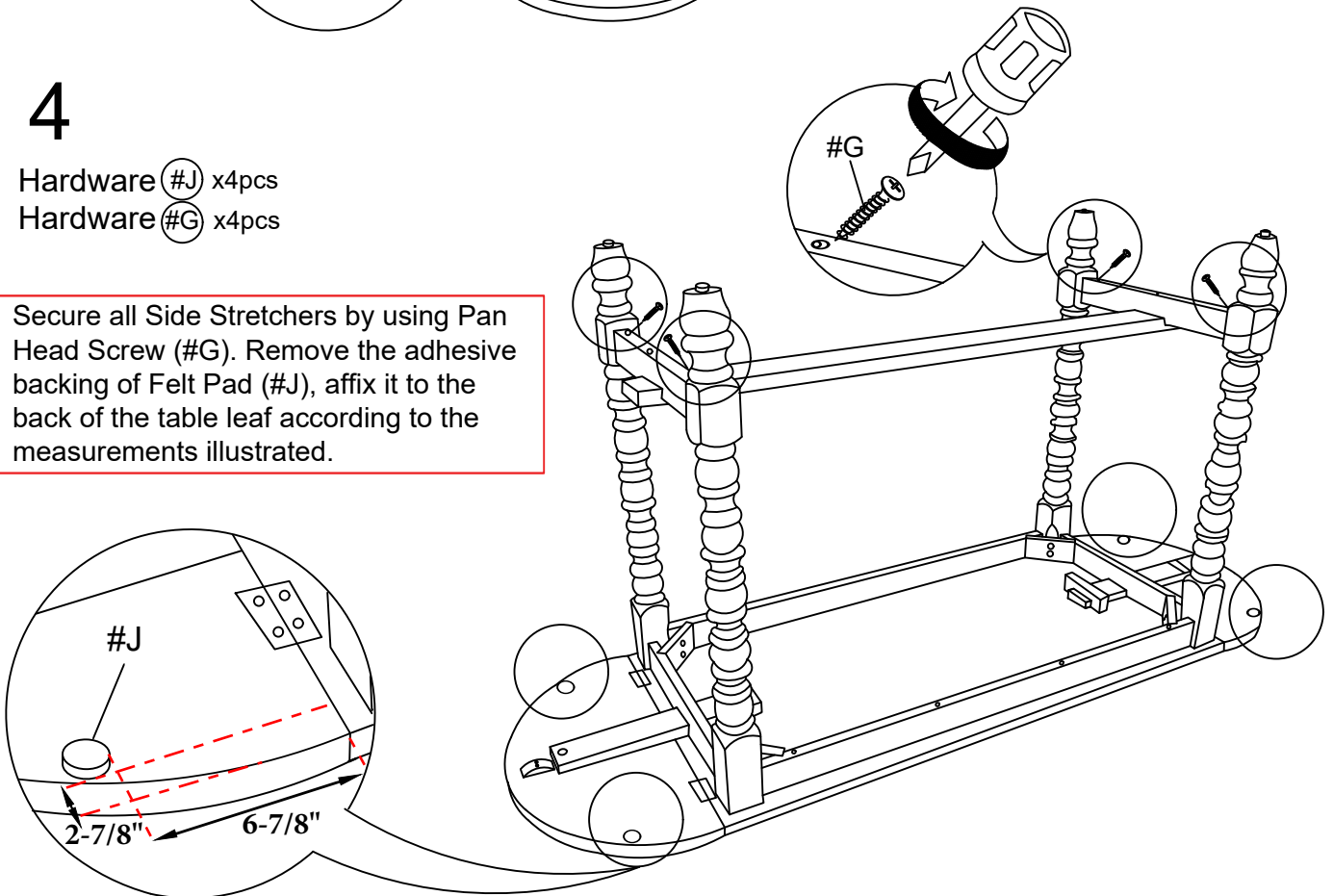

ASSEMBLY INSTRUCTIONS

5

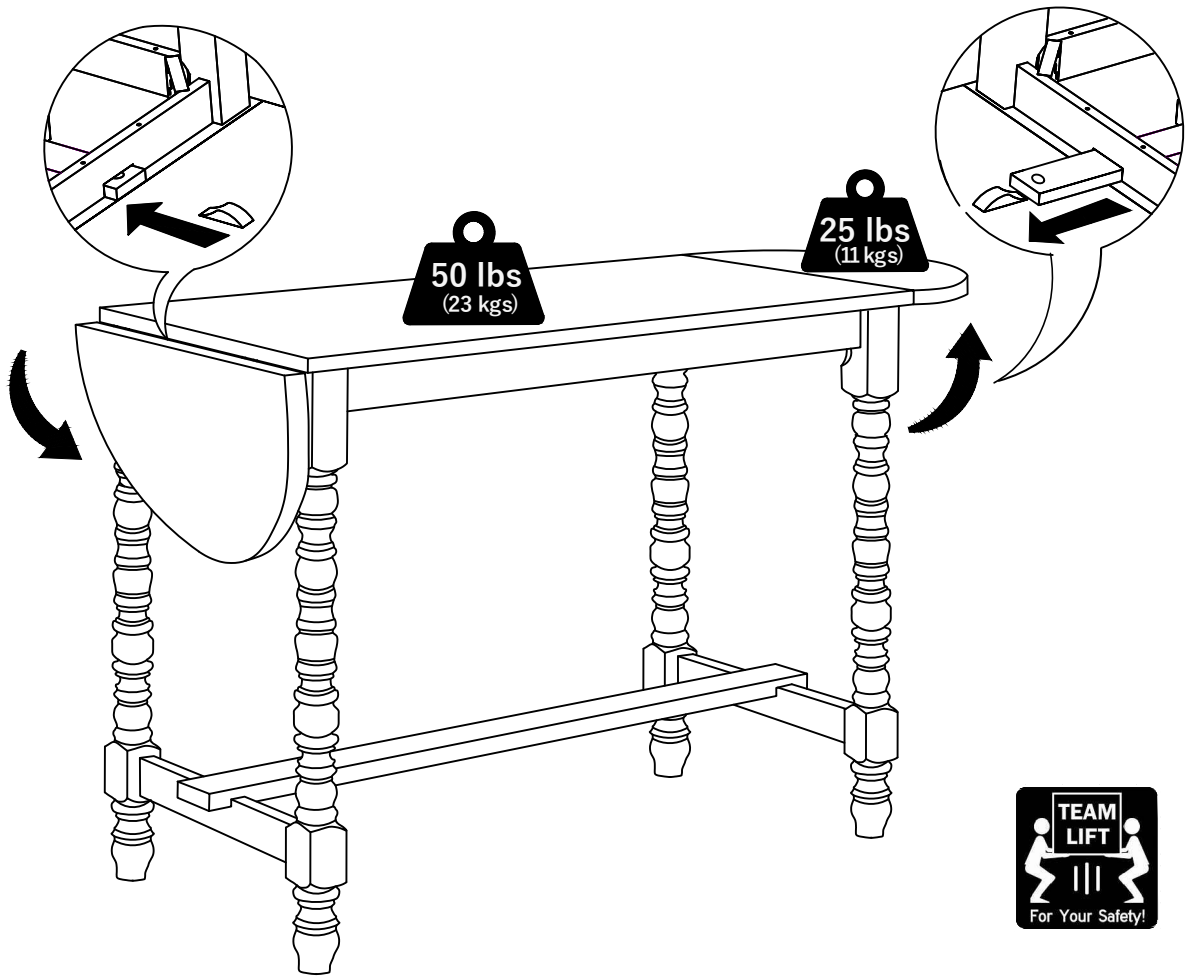

6

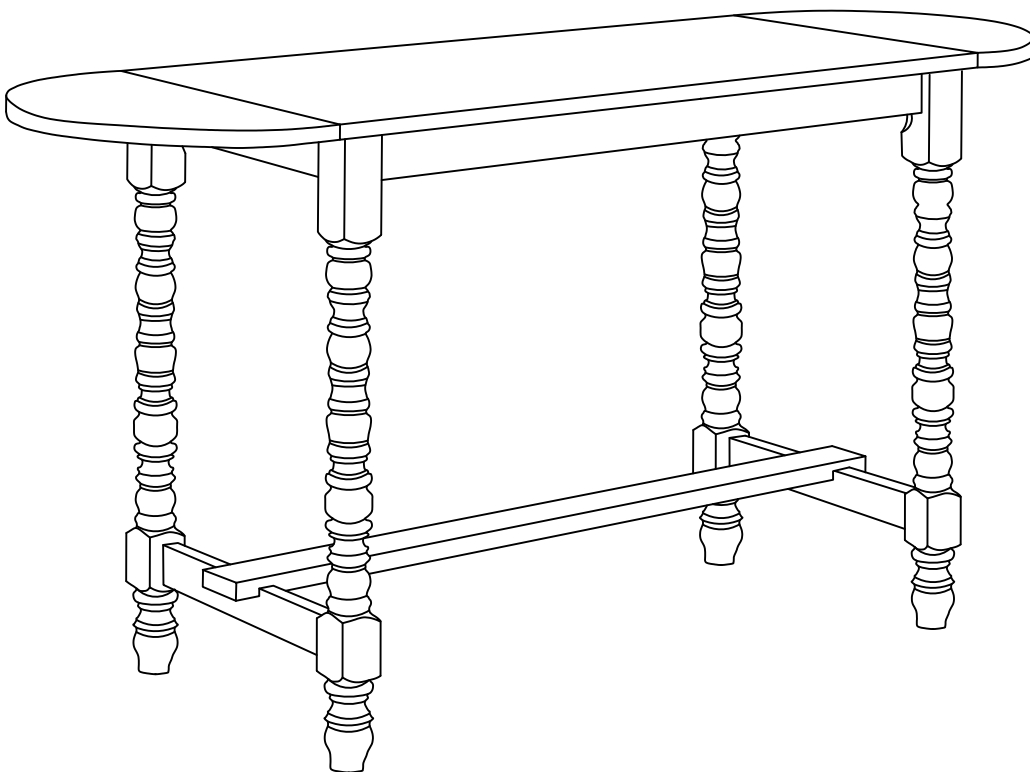

ASSEMBLY COMPLETED



Please ensure the furniture rests on an even and flat surface. If the product wobbles or feels loose, double-check all bolts and/or screws are properly tightened and secured.



Keep this handy!

Please retain this instruction manual and any order-related information for future reference.



Lift, don't drag!

To avoid damage to product please always LIFT the product when transporting or adjusting the placement.