

ASSEMBLY INSTRUCTION

ITEM NO: 97211

Thank you for purchasing this quality product. Be sure to check all packing material carefully for small parts which may have come loose inside the carton during shipment. Separate, identify, and count all parts and metal hardware. Compare with parts list to be sure all parts are present.

PARTS

(A) Armoire (1 piece)
(B) Metal leg (4 pieces)

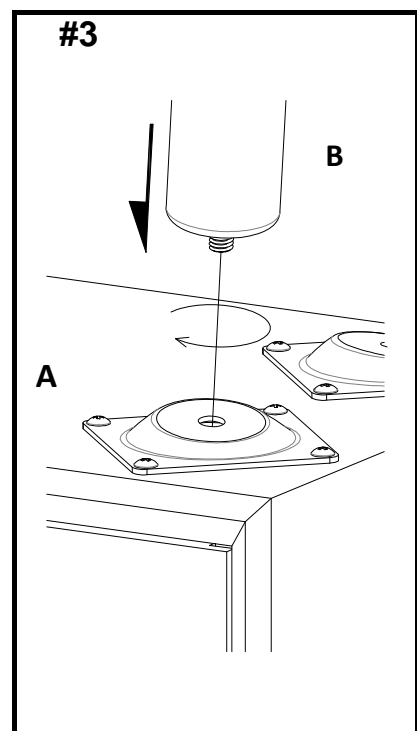
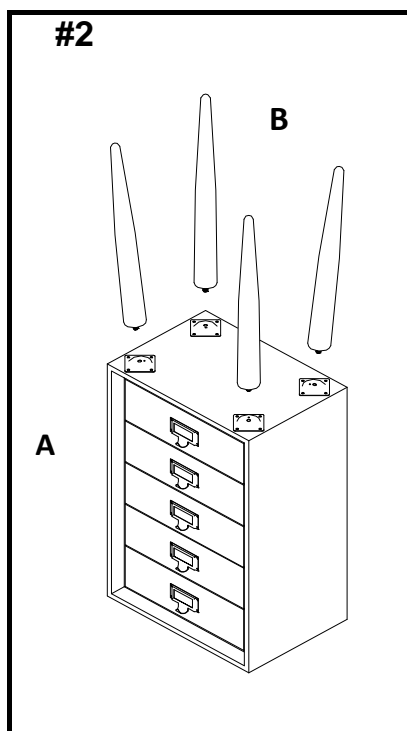
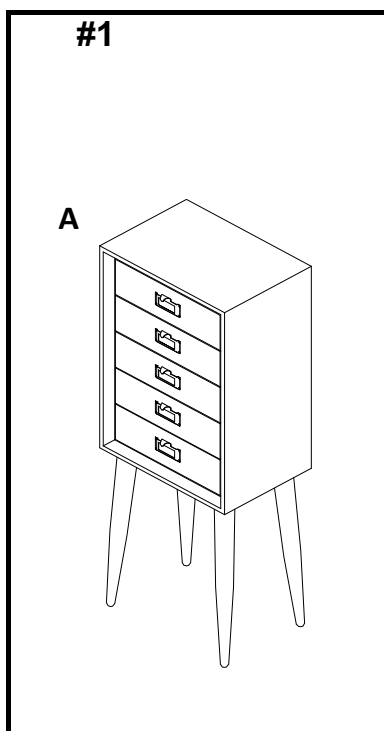

IMPORTANT NOTE: Follow instructions listed below in the proper sequence as numbered to assure fast, easy and correct assembly.

1. Please find 4 legs in an inner box inside carton.
2. Place armoire (A) upside down on a soft cloth. Insert metal legs (B) into the iron plate then tighten as illustration #2. #3.
3. Carefully move the armoire to stand upright in normal position after assembling the four legs and adjust properly as final step.
4. Your furniture has been handcrafted and skillfully finished by fine craftsmen. However, should you desire a shinier finish. Simply use any good grade of furniture polish to rub the finish lightly as it is being applied. Allow to dry and buff lightly with a soft cloth.

PRINTED IN TAIWAN

Assembly Instruction of Anti-tipping hardware

1. Drill 1 hole in the wall at the location expected.

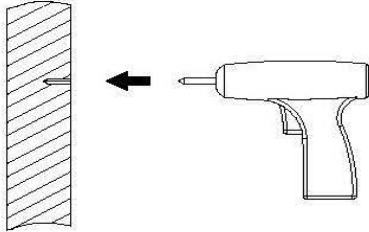

2. Install wall anchor into the hole with a hammer.

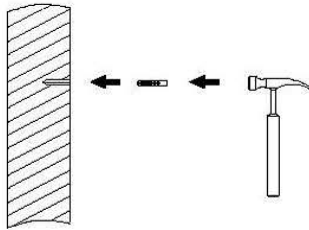

3. Position the armoire so that it is flush against the wall.

4. Pull up on the strap until it is tight.

5. Using the supplied screws and washer, secure the strap to the wall anchor as shown.

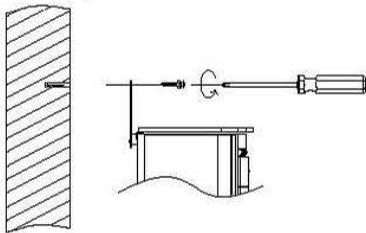

WARNING

Injury may result from tipping furniture

This restraint is not a substitute for proper adult supervision.
This restraint may provide protection against tipping furniture.

Do not allow children to climb on furniture.

Failure to detach this restraint before moving furniture may
result in injury and damage.